

# TL6330 SERIES TACT SWITCH

## APPLICATIONS / MARKETS

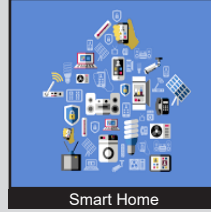
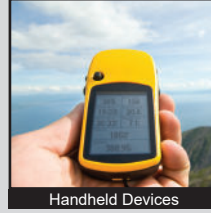

**RoHS**

## SPECIFICATIONS

**Contact Rating:** 50mA @ 32VDC  
**Electrical Life:** 200gf - 200,000 Cycles  
 300gf - 150,000 Cycles  
 400gf - 100,000 Cycles  
**Contact Resistance:** 100mΩ Max  
**Insulation Resistance:** 1GΩ Min @ 500VDC  
**Dielectric Strength:** 250VAC for 1 Minute  
**Operating Temperature:** -40°C to 85°C  
**Storage Temperature:** -40°C to 85°C  
**Travel:** 0.25mm  
**Contact Arrangement:** SPST  
**Actuation Force:** 200gf, 300gf, 400gf  
**Dust/Moisture Protection:** IP67

## FEATURES & BENEFITS

- Surface mount PC board design
- Long Cycle Life up to 200,000 Cycles
- Small package size of 2.80mm x 4.60mm
- Multiple actuator height options: 1.90mm, 2.50mm
- Multiple actuation force options: 200gf, 300gf, 400gf
- IP67 rating

## PART NUMBER CONFIGURATOR

Series



TL6330

Actuator Options



A - 1.90mm  
 B - 2.50mm

Actuation Force



F200 - 200 gf  
 F300 - 300 gf  
 F400 - 400 gf

Contact Material



Q - Silver

Specifications subject to change without notice 8.17.2022



**E-SWITCH®**

www.e-switch.com

800.867.2717

1

# TL6330 SERIES TACT SWITCH

## BODY DIMENSIONS

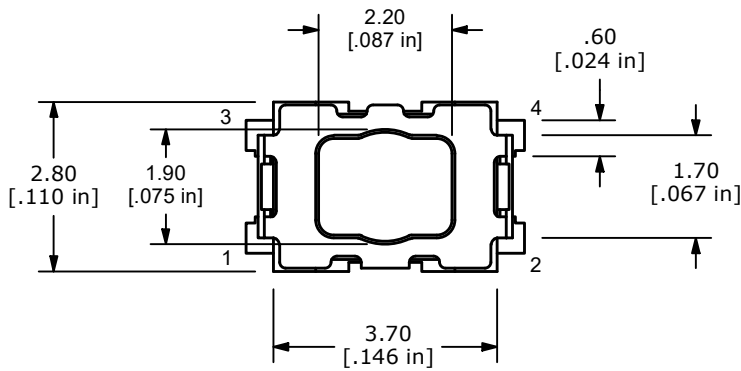
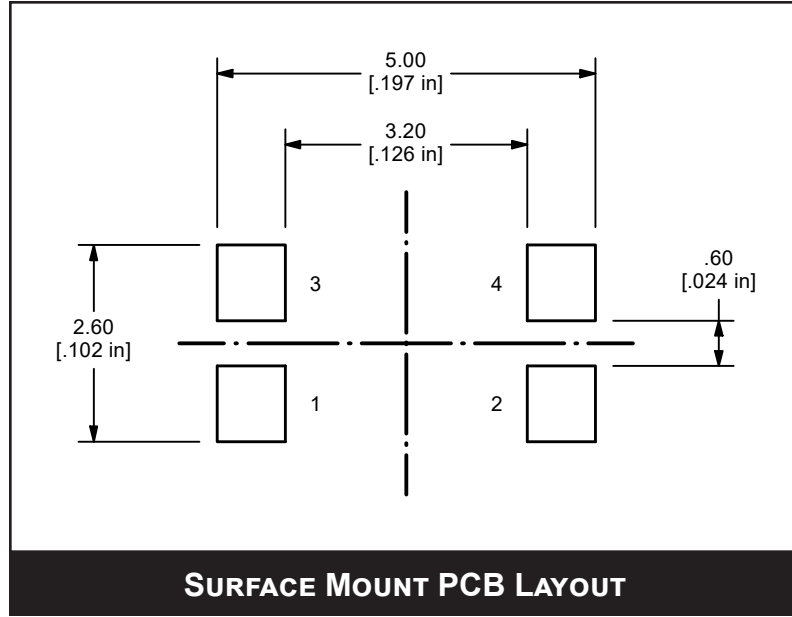
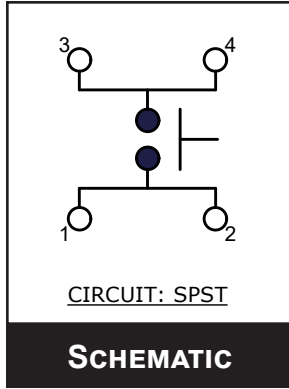

| ACTUATOR | "L"  |
|----------|------|
| A        | 1.90 |
| B        | 2.50 |

